

HAMILTON JET ANODES

ZINC PART	DIMENSIONS (INCHES)	HOLE (S) INCHES	LBS
HJ-102185-4	4 dia x 1 thick	.36 dia	2.6
HJ-103359	1 x 1 x 3.2	.36 dia, 2.2 OC	0.6
HJ-103862	6.75 dia x 2.25	.63 dia, 2.75 OC	18.5
HJ-104634	1 x 1 x 4	.36 dia, 3.1 OC	0.6
HJ-105447	1.75 dia x 1	.75 dia	0.23



HJ-102185-4



HJ-103862



HJ-105447



HJ-103359 HJ-104634

MAXI PROPELLER ANODES



MAXI

PART	DIMENSIONS (INCHES)	BOLT CIRCLE	LBS
ZMP-63	1.75 high x 1.56 I.D.	1.83	0.75
ZMP-70	1.85 high x 1.63 I.D.	1.96	1.12
ZMP-83	2.37 high x 1.8 I.D.	2.37	2

ARNESON ANODES

ZINC PART	DIMENSIONS (INCHES)	HOLE (S) DIA	LBS
ARNESON-SMALL	1.25 x 1.18 x .6	3.5	1.25
ARNESON-LARGE	1.81 x 1.87 x 7.5	5	3.75



ARNESON

OCEANOGRAPHIC INSTRUMENT

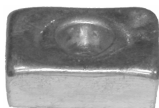

ZOI-1



ZOI-2

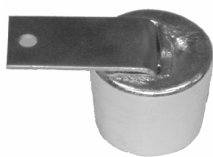

ZOI-4



ZOI-3



ZOI-5 ZOI-6

ZINC PART	DIMENSIONS (INCHES)	HOLES / CORES (INCHES)	LBS
ZOI-1	.75 x 1.5 x 2	.28 dia x .5 c'sink	0.5
ZOI-2	.75 x 1.5 x 4	as above, 1.95 OC	1.1
ZOI-3	.87 x 1.25 x 3.75	.1 x .5 x 5.5	0.3
ZOI-4	1.75 dia x 1.25	.06 x 1 x 2 SS	0.7
ZOI-5	1.75 dia x 1.25	.25 NC x .37 SS	0.7
ZOI-6	2 dia x 2	.25 NC x .37 SS	1.5

CUSTOM PLATES

TYPE	DIMENSIONS	LBS
CAST	To Customer Specs	.258 lbs / cubic in
ROLLED		
CUSTOM CUTS		

